

# USB TYPE-C母座立式沉板16Pin数据接口5A厂家LZG带防护胶头连接器

产品名称	USB TYPE-C母座立式沉板16Pin数据接口5A厂家LZG带防护
生产厂家	广东小迈实业有限公司
价格	/
规格参数	品牌:LZG Type-C:5A立式沉板16Pin MPQ:600PCS/盘
公司地址	东莞市横沥镇西城一区西聚路1号
联系电话	18938295875

## 产品详情

### USB TYPE-C母座立式沉板16Pin数据接口5A厂家LZG带防护胶头连接器

规格：ZB48011-16SBAP-A

端口数量：1，安装类型：立式插板，额定电流：5A



ZB48011-16SBAP-A



**USB TYPE-C**

精益求精 臻于至善

**5A** MAX

# 产品应用



汽车领域  
Automotive Electronics Field



数码产品  
Digital Product



电子产品  
Electronics



家用电器  
Household Appliances



影音产品  
Audio and video products



通信产品  
Communication Products



智能家居  
Smart Home



## 专注防水连接器生产制造



# USB TYPE-C

源头工厂

支持定制

免费拿样



# USB

ZB48011-16SBAP-A

TYPE C 系列

## 生产厂家 欢迎来访



## USB TYPE C Serie

### ∨ NOTES:

---

#### 1. MECHANICAL PERFORMANCE:

- 1-1. INSERTION FORCE: 0.5~2.0kgf.
- 1-2. REMOVAL FORCE: 0.8kgf~2.0kgf.
- 1-3. DURABILITY: 10000 CYCLES.

#### 2. ELECTRICAL PERFORMANCE:

2-1. VOLTAGE RATING: 5 V DC/AC (RMS. max)

CURRENT RATING: 5 AMPS. FOR TOTAL VBUS/GND PINS.

1.25AMPS FOR CC PIN, 0.25 AMPS. FOR ALL OTHER CONTACT.

2-2. LLCR: VBUS & GND PINS AND OTHER PINS: 40mΩ/PIN MAX.

SHIELD: 50mΩ/MAX. LLCR MAX. CHANGE OF ALL PINS: 10mΩ.

2-3. INSULATION RESISTANCE: 100MΩ MIN

ISO  
9001:2015

✓  
RoHS

✓ ISO  
14001:2015



**LZG INDUSTRIAL CO.,LTD**

RoHS  
Compliant

ZONE	ECN. NO.	DESCRIPTION	DRAWING	DATE
A		INITIAL	林生財	2020.02.18

1. MECHANICAL PERFORMANCE:  
 1-1. INSERTION FORCE: 0.5~2.0kgf.  
 1-2. REMOVAL FORCE: 0.8kgf~2.8kgf.  
 1-3. DURABILITY: 10000 CYCLES.  
 2. ELECTRICAL PERFORMANCE:  
 2-1. VOLTAGE RATINGS: V DC/AC (RMS. max)  
 CURRENT RATINGS: AMPS. FOR TOTAL VBUS/GND PINS;  
 1.25AMPS FOR CC PIN, 0.25 AMPS. FOR ALL OTHER CONTACT.  
 2-2. LLOR:  
 VBUS & GND PINS AND OTHER PINS: 40mΩ/PIN MAX.  
 SHIELD: 50mΩ/MAX.  
 LLOR MAX. CHANGE OF ALL PINS: 10mΩ.  
 2-3. INSULATION RESISTANCE: 100MΩ MIN.  
 2-4. DIELECTRIC WITHSTAND VOLTAGE: AC 100V FOR 1 MINUTE.  
 3. ENVIRONMENTAL PERFORMANCE:  
 OPERATING TEMPERATURE: -25°C~+85°C.  
 4. AIR FLOW:  
 THE PEAK TEMPERATURE ON THE BOARD SHALL  
 BE MAINTAINED FOR 10 SECONDS AT 260°C.

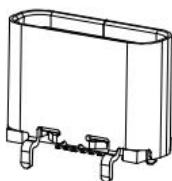
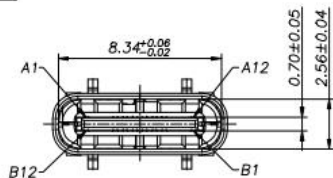

3D VIEW

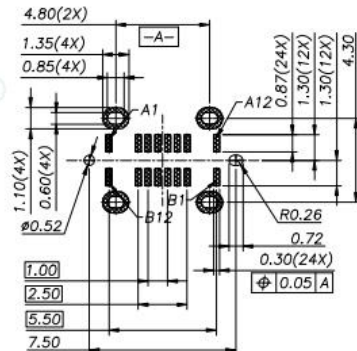
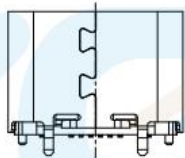
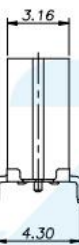
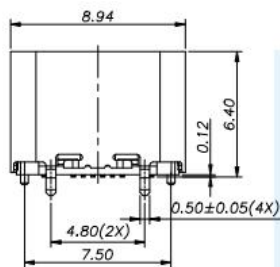

RECOMMENDED PCB LAYOUT(TOP VIEW)  
 THICKNESS 0.8±0.10MM; DEFAULT TOLERANCE: ±0.05

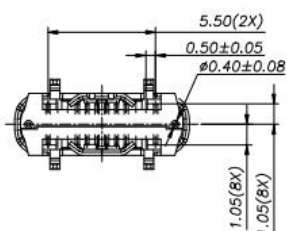

NO.	DESCRIPTION	MATERIAL	REMARKS	QTY
4	FRONT SHELL	STAINLESS STEEL	≧ 50μ" MIN. UNDER PLATED OVER ALL.	1
3	MD PLATE	STAINLESS STEEL	CLEAN	1
2	TERMINAL	COPPER ALLOY	≧ 50μ" MIN. UNDER PLATED OVER ALL. PLATED ON THE FUNCTIONAL AREA OF CONTACT. GOLD PLATING THICKNESS FOLLOW THE P/N PLATING SPECIFICATIONS OF THE SOLID. AND FOLLOW THE P/N.	16
1	HOUSING	LCP 94V-0	COLOR BLACK or WHITE or NATURE	1

**LZG** LZG INDUSTRIAL CO. LTD

DRAWING:	林生財	DATE:	2020.02.18	SCALE	1:1
CHECK:	李安鑫	DATE:	2020.02.18	MATERIAL	*
APPROVAL:	黃建堂	DATE:	2020.02.18	DWG. NO.	
DRAWING NO.	ZB48011-16SBAP-A			SHEET	1/2

PART NAME	TYPE C 16 PIN	TOLERANCE UNLESS	0.0±0.3	0.°±2"	UNIT:
PART NO.	ZB48011-16SBAP-A	OTHERWISE SPECIFIED:	0.00±0.2 0.000±0.1	0.0°±1" 0.00°±0.5'	mm