

防水TYPE-C母座沉板1.53双耳16Pin防水IPX7充电接口3A厂家LZG

产品名称	防水TYPE-C母座沉板1.53双耳16Pin防水IPX7充电接口3A厂家
生产厂家	广东小迈实业有限公司
价格	/
规格参数	品牌:LZG Type-C:16pin双耳3A 特性:防水IPX7
公司地址	东莞市横沥镇西城一区西聚路1号
联系电话	18938295875

产品详情

防水TYPE-C母座沉板1.53双耳16Pin防水IPX7充电接口3A厂家LZG

产品参数：

型号：ZB48025-16SBAP-A

包装：800/盘



ZB48025-16SBAP-A

IPX7

IP67

3A



防水Type-C接口

致力提供防水连接器解决方案

防水





Type-C接口

源头工厂

支持定制

免费拿样



防水

ZB48025-16SBAP-A

生产厂家 欢迎来访

产品应用



汽车领域
Automotive Electronics Field



数码产品
Digital Product



电子产品
Electronics



家用电器
Household Appliances



影音产品
Audio and video products



通信产品
Communication Products



智能家居
Smart Home



专注防水连接器生产制造



waterproof TYPE C serie

✓ NOTES:

1. CURRENT RATING: 3.0A MAX.
2. DIELECTRIC WITHSTAND VOLTAGE: 100VAC.
3. TEMPERATURE RANGE: -30°C~ 85°C.
4. CONTACT RESISTANCE: 40 MILLIONHM MAX.
5. INSULATION RESISTANCE: 100 MEGOHMS MIN.
6. INSERTION FORCE : 5N~20N.
7. UNMATING FORCE: 8N~20N.
8. DURABILITY: 10,000 CYCLES.

ISO
9001:2015

✓
RoHS

✓ ISO
14001:2015



LZG INDUSTRIAL CO.,LTD

RoHS
Compliant



ZONE	EC N. NO.	DESCRIPTION	DRAWING	DATE
A		INITIAL	林生財	2020.02.18

SPECIFICATIONS:

1. CURRENT RATING: 3.0A MAX
2. DIELECTRIC WITHSTAND VOLTAGE: 100VAC
3. TEMPERATURE RANGE: -30 °C ~ 85 °C
4. CONTACT RESISTANCE: 40 MILLIONHM MAX
5. INSULATION RESISTANCE: 100 MEGOHMS MIN.
6. INSERTION FORCE : 5N~20N
7. UNMATING FORCE: 8N~20N
8. DURABILITY:10,000 CYCLES

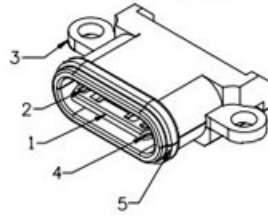
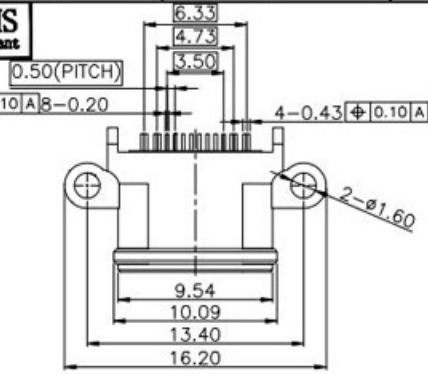

3D VIEW

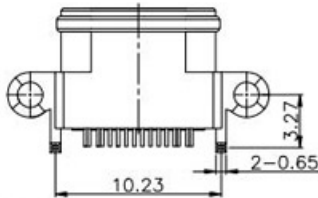
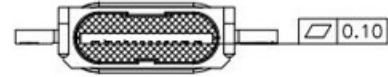
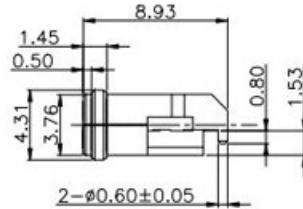
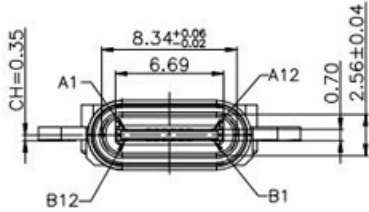

5	WATERPROOF RING	SILICA GEL	COLOR BLACK	1
4	Medium Iron sheet	SUS304 1/2H		1
3	OUTER SHELL	ZINC ALLOY	NI PLATING	1
2	CONTACT	C7025;	Au3u*PLATING T=0.15mm	16
1	HOUSING	PA10T	COLOR BLACK	1
NO.	DESCRIPTION	MATERIAL	REMARKS	QTY



LZG INDUSTRIAL CO. LTD

DRAWING:	林生財	DATE:	2020.02.18	SCALE:	1:1
CHECK:	李宏偉	DATE:	2020.02.18	MATERIAL:	*
APPROVAL:	黃建寬	DATE:	2020.02.18	DWG. NO.:	
DRAWING NO.:	ZB48025-16SBAP-A			SHEET:	1/2

PART NAME	WATERPROFF TYPE C 16PIN	TOLERANCE UNLESS	0.0±0.3	0.1±0.2	UNIT:	mm
PART NO.	ZB48025-16SBAP-A	OTHERWISE SPECIFIED:	0.00±0.1	0.0'±1'		
			0.000±0.05	0.00'±0.5'		