

## 防水Type-C母座立贴16Pin3脚插板充电接口3A厂家LZG接插件

|      |   |
|------|---|
| 产品名称 | 防水Type-C母座立贴16Pin3脚插板充电接口3A厂家LZG接插件     |
| 生产厂家 | 广东小迈实业有限公司                              |
| 价格   | /                                       |
| 规格参数 | 品牌:LZG<br>Type-C:16pin立贴3A<br>特性:防水IPX7 |
| 公司地址 | 东莞市横沥镇西城一区西聚路1号                         |
| 联系电话 | 18938295875                             |

### 产品详情

#### 防水Type-C母座立贴16Pin3脚插板充电接口3A厂家LZG接插件

##### 产品参数

型号：ZB48003-16SBAP-A

包装：500/盘



ZB48003-16SBAP-A

**IPX7**

**IP67**

**3A**



**防水Type-C接口**

致力提供防水连接器解决方案

**防水**





# Type-C接口

源头工厂

支持定制

免费拿样



# 防水

ZB48003-16SBAP-A

## 生产厂家 欢迎来访

# 产品应用



汽车领域  
Automotive Electronics Field



数码产品  
Digital Product



电子产品  
Electronics



家用电器  
Household Appliances



通信产品  
Communication Products



影音产品  
Audio and video products



智能家居  
Smart Home



## 专注防水连接器生产制造



## waterproof TYPE C serie

### ✓ NOTES:

---

1. CURRENT RATING: 3.0A MAX
2. DIELECTRIC WITHSTAND VOLTAGE: 100VAC
3. TEMPERATURE RANGE: -30 °C ~ 85 °C
4. CONTACT RESISTANCE: 40 MILLIONHM MAX
5. INSULATION RESISTANCE: 100 MEGOHMS MIN.
6. INSERTION FORCE : 5N~20N
7. UNMATING FORCE: 8N~20N
8. DURABILITY:10,000 CYCLES
9. WATER PROOFNESS: THIS PRODUCT  
IS BASED ON IPX8.

ISO  
9001:2015

✓  
RoHS

✓ ISO  
14001:2015



**LZG INDUSTRIAL CO.,LTD**

RoHS  
Compliant



| ZONE | EC N. NO. | DESCRIPTION | DRAWING | DATE       |
|------|-----------|-------------|---------|------------|
| A    |           | INITIAL     | 林生財     | 2020.02.18 |

SPECIFICATIONS:

1. CURRENT RATING: 3.0A MAX
2. DIELECTRIC WITHSTAND VOLTAGE: 100VAC
3. TEMPERATURE RANGE: -30 °C ~ 85 °C
4. CONTACT RESISTANCE: 40 MILLIONHM MAX
5. INSULATION RESISTANCE: 100 MEGOHMS MIN.
6. INSERTION FORCE : 5N~20N
7. UNMATING FORCE: 8N~20N
8. DURABILITY:10,000 CYCLES

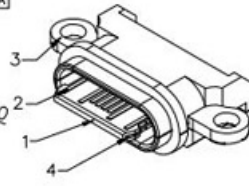
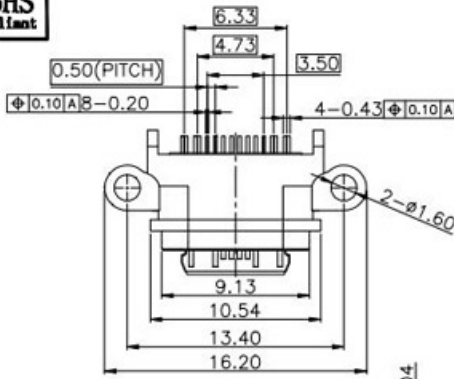

3D VIEW

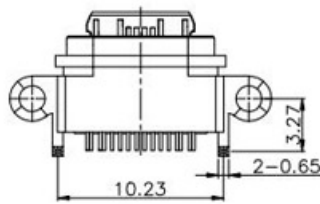
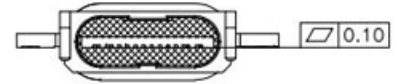
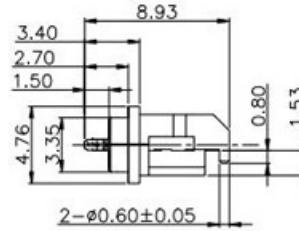
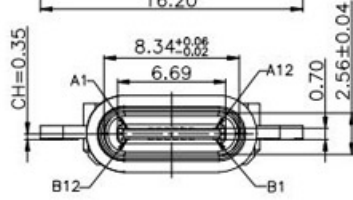

| 5   | WATERPROOF RING   | SILICA GEL  | COLOR BLACK           | 1   |
|-----|-------------------|-------------|-----------------------|-----|
| 4   | Medium iron sheet | SUS304 1/2H |                       | 1   |
| 3   | OUTER SHELL       | ZINC ALLOY  | NI PLATING            | 1   |
| 2   | CONTACT           | C7025       | Au3u*PLATING T=0.15mm | 16  |
| 1   | HOUSING           | PA10T       | COLOR BLACK           | 1   |
| NO. | DESCRIPTION       | MATERIAL    | REMARKS               | QTY |

**LZG** LZG INDUSTRIAL CO. LTD

|             |                  |       |            |           |     |
|-------------|------------------|-------|------------|-----------|-----|
| DRAWING:    | 林生財              | DATE: | 2020.02.18 | SCALE:    | 1:1 |
| CHECK:      | 李安倫              | DATE: | 2020.02.18 | MATERIAL: | *   |
| APPROVAL:   | 劉建宏              | DATE: | 2020.02.18 | DWG. NO.  |     |
| DRAWING NO. | ZB48026-16SBAP-A |       |            | SHEET     | 1/2 |

|           |                         |                                       |                                   |                                 |          |
|-----------|-------------------------|---------------------------------------|-----------------------------------|---------------------------------|----------|
| PART NAME | WATERPROFF TYPE C 16PIN | TOLERANCE UNLESS OTHERWISE SPECIFIED: | 0.0±0.3<br>0.00±0.1<br>0.000±0.05 | 0.°±2°<br>0.0°±1°<br>0.00°±0.5° | UNIT: mm |
| PART NO.  | ZB48026-16SBAP-A        |                                       |                                   |                                 |          |