

# 防水TYPE-C母座沉板前贴后插双排24Pin防水IPX7充电接口3A厂家LZG

产品名称	防水TYPE-C母座沉板前贴后插双排24Pin防水IPX7充电接口
生产厂家	广东小迈实业有限公司
价格	/
规格参数	品牌:LZG Type-C:沉板24Pin双排3A 特性:防水IPX7
公司地址	东莞市横沥镇西城一区西聚路1号
联系电话	18938295875

## 产品详情

### 防水TYPE-C母座沉板前贴后插双排24Pin防水IPX7充电接口3A厂家LZG

产品详情：

型号：ZB48031-24FBAP-A

包装：800/盘



ZB48031-24FBAP-A

**IPX7**

**IP67**

**5A**



**防水Type-C接口**

致力提供防水连接器解决方案

**防水**





Type-C接口

源头工厂

支持定制

免费拿样



防水

ZB48031-24FBAP-A

生产厂家 欢迎来访

# 产品应用



汽车领域  
Automotive Electronics Field



数码产品  
Digital Product



电子产品  
Electronics



家用电器  
Household Appliances



通信产品  
Communication Products



影音产品  
Audio and video products



智能家居  
Smart Home



## 专注防水连接器生产制造





## waterproof TYPE C serie

### ✓ NOTES:

---

#### 1. ELECTRICAL:

1.1. CONTACT CURRENT RATING 5.0A FOR  
VBUS AND GND(PINS A4 A9 B4 B9)

1.2. INSULATION RESISTANCE: 100 MEGAOHMS MIN. AT 250VDC.

1.3. DIELECTRIC WITHSTANDING VOLTAGE: 100VAC MIN.

1.4. LOW CONTACT RESISTANCE:

INITIAL 40mΩ MAX. AFTER 50mΩ MAX.

#### 2. MECHANICAL CHARACTERISTICS:

2.1. INSERTION FORCE: 5N~20N.

2.2. EXTRACTION FORCE: 8N~20N FORM 1 TO 1000CYCLES.

6~20N FORM 1001 TO 10000CYCLES.

2.3. DURABILITY: 10,000 MATING CYCLES

2.4. OPERATING TEMPERATURE: -55°C TO +85°C

ISO  
9001:2015

✓  
RoHS

✓ ISO  
14001:2015



**LZG INDUSTRIAL CO.,LTD**

RoHS  
Compliant

ZONE	ECN.NO.	DESCRIPTION	DRAWING	DATE
A		INITIAL	林生財	2020.02.18

SPECIFICATIONS:

1.ELECTRICAL:

1-1:CURRENT RATING:  
VBUS AND GND CONTACTS RATED AT 1.25A  
PARALLELED FOR A TOTAL OF 5A;

1-2:INITIAL CONTACT RESISTANCE :40 MEGOHMS

1-3:DIELECTRIC WITHSTANDING VOLTAGE:  
100V AC MIN;

2:MECHANICAL CHARACTERISTICS:

2-1:MATING FORCE:5~20N

2-2:UNMATING FORCE:8~20N(INITIAL),  
6~20N(AFTER 10000 CYCLES)

2-3:FREQUENCY: 200±50 CYCLES /HOUR,10000 CYCLES

2-4:OPERATING TEMPERATURE ;-40°~80°.

3: WATERPROOF: IP-X7.

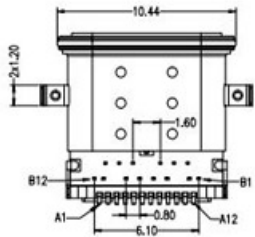
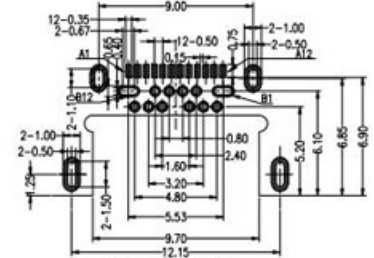
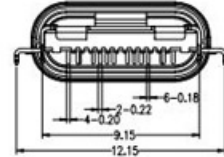
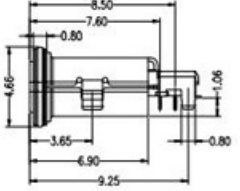
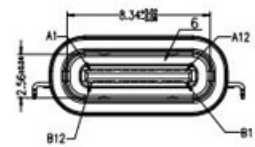
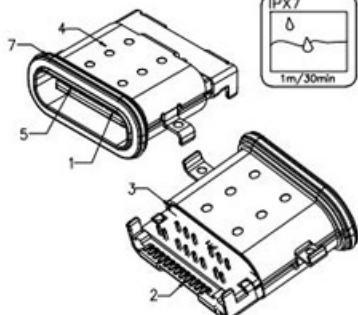
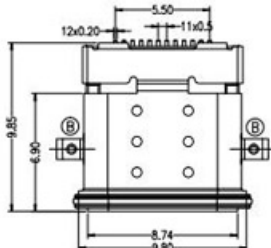

PIN	SIGNAL NAME	PIN	SIGNAL NAME	no.	DESCRIPTION	MATERIAL	REMARKS	QTY
A1	GND	B12	GND	7	RING	SILICON	-----	1 PCS
A2	SSTXP1	B11	SSRX1	6	MID-PLANT	STAINLESS STEEL	-----	1 PCS
A3	SSTXN1	B10	SSRXN1	5	GND-PLANT	STAINLESS STEEL	NI/SN PLATING	1 PCS
A4	VBUS	B9	VBUS	4	SHELL	STAINLESS STEEL	-----	1 PCS
A5	CC1	B8	SBU2	3	INNER SHELL	STAINLESS STEEL	-----	1 PCS
A6	DP1	B7	DN2	2	CONTACT	COPPER ALLOY	NI PLATING	1 PCS
A7	DN1	B6	DP2	1	HOUSING	HIGH TEMPERATURE PLASTIC	COLOR BLACK	1 PCS
A8	SBU1	B5	CC2					
A9	VBUS	B4	VBUS					
A10	SSRXN2	B3	SSTXN2					
A11	SSRX12	B2	SSTX12					
A12	GND	B1	GND					

**LZG** LZG INDUSTRIAL CO. LTD

DRAWING:	林生財	DATE:	2020.02.18	SCALE:	1:1
CHECK:	李成龍	DATE:	2020.02.18	MATERIAL:	*
APPROVAL:	林建堂	DATE:	2020.02.18	DWG. NO.:	
DRAWING NO.:	ZB48031-24FBAP-A			SHEET:	1/1

PART NAME	WATERPROFF TYPE C 24PIN	TOLERANCE UNLESS OTHERWISE SPECIFIED:	0.0±0.3 0.00±0.2 0.000±0.05	0°±2' 0.0°±1' 0.00°±0.5'	UNIT: mm
PART NO.	ZB48031-24FBAP-A				